

8. Back cover board 3 installation

- a. Take down 4pcs M5 screws and gasket from the stand pipe.
- b. Put the well connected circuitry into the stand pipe groove, fix up back cover board 3 on the stand pipe by those screws and gaskets. Refer to Picture 8.

Picture 8

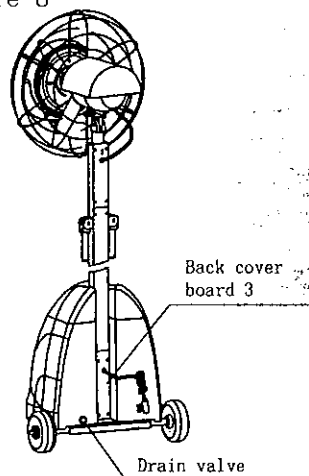

9. Tube installation

Take off the water tank cover, set the pump tube and circumfluence tube into corresponding tie-in, use the poop to fixup them, then covered with the water tank cover, please note: pump tube, circumfluence tube and pump power supply wire all should through the U shape groove of the water tank cover. Refer to Picture 9.

Picture 9

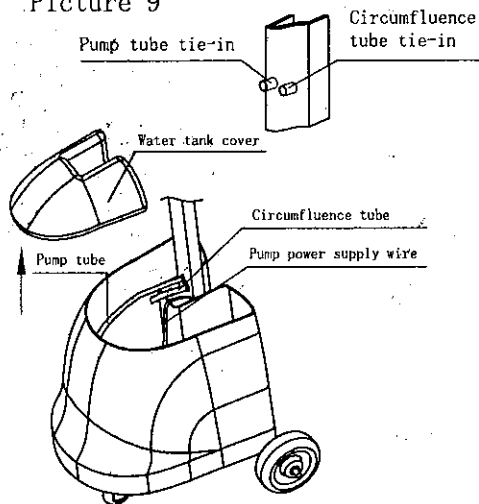

10. Operating inspection

- a. Fill clean water into the tank, cover tank cover.
- b. Turn ball clique from "ON" to "OFF", Get through the power supply, pull the first speed-adjusting switch and check the atomizing motor and blade operating.
- c. Pull the back misting switch, check the atomizing motor, pump, mixing plate operating.
- d. Turn ball valve from "OFF" to "ON" and check atomizing status. Refer to Picture 10.

Picture 10

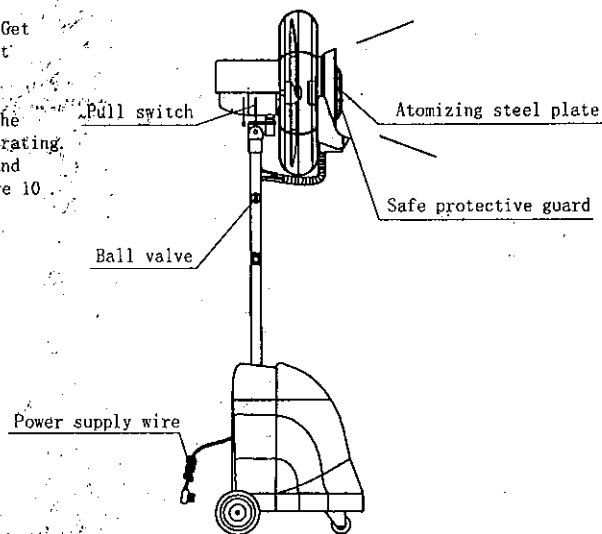

11. Instruction for handle

Handle for this series product can be kept in and out. If there is a need to move the machine, push forward type L pin of handle joining and turn the handle upwards 90 degree, while flexible washer of the pin touches handle joining, shorter end of type L pin can insert the fixing hole in the handle joining under pressure of spring so that the handle is fixed and the machine can be moved forward. If there is a need to keep in the handle, push forward type L pin of handle joining and while flexible washer of the pin touches handle joining, the shorter end of type L pin leaves the fixing hole in the handle, then turn the handle downwards 90 degree. Refer to Picture 11.

Picture 11

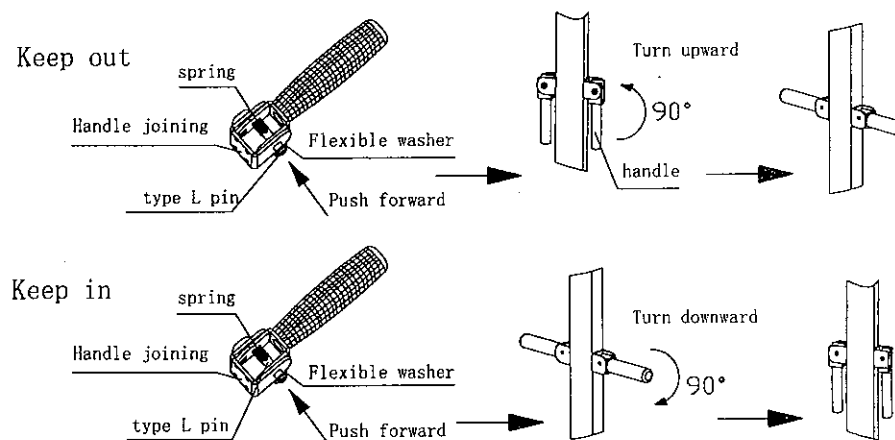

OUTER DIMENSION

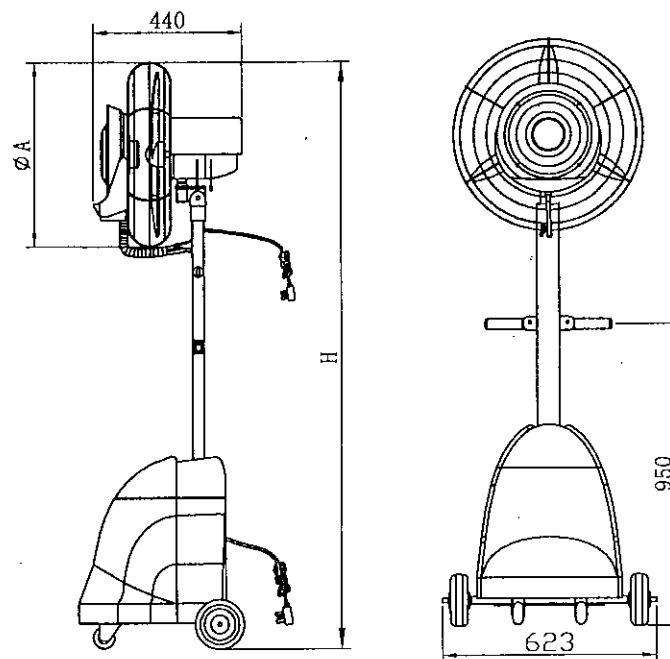

Performance Model	Item	ϕA	H
	IMF-650		$\phi 710$